

# Wired-300

## GPS Tracker Getting Started Guide

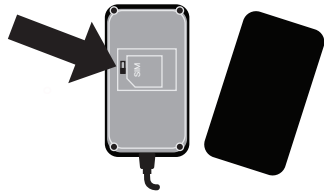

### 1 Switch internal power on

Open the device cover and locate the internal power switch. Turn the switch to "on" and you should notice lights flash indicating power. You can then close the cover and place the device. Mount the tracker with the adhesive pad.



### 2 Connect your tracker to a vehicle

To install, connect the red and black wires on the provided cable to your vehicle power source. Once the vehicle is turned on the tracker will then begin reporting location.

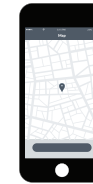

### 3 Download the tracking app

Download the mobile app from the App Store or Play Store by searching for "logistimatics". You can also track from any web browser at [gps.logistimatics.com](https://gps.logistimatics.com)



### 4 Login with email and password

Login to the app with your email address and the password you used when you purchased the tracker.

## Wired-300 features and options

### Tracker reporting frequency

The tracker will report its location every 30 seconds when moving. The device will have to be wired up to a vehicle and in most cases the vehicle will have to be running for reporting to take place.

### Engine runtime log (optional)

You have the option to connect the orange wire to the vehicle's ignition ON circuit. When connected, your tracker will also report the engine status (running or off) in addition to location data.

### The Wired-300 is a 3G tracker

Many trackers work on the 2G network. The Wired-300 works on the 3G cellular network and can give you more reliability in more places than a 2G tracking device.

### Historic locations

The tracking app will show you where the tracker is right now and everywhere it has been. The app will automatically store all the positions over the last 60 days.



### Tracker Placement

Where you place the tracker will be dependent upon where the tracker is wired into your vehicle. You may have to search for a spot that works for your use case if you want the device to stay hidden and out of the way.



### Setting up alerts

To be notified if your tracker enters or exits an area, create a geofence. In the mobile app, click Geofences > New Geofence. Give your new geofence a name, address and size.



### Troubleshooting

If you have a question or problem, we can help. Learn more about your tracker's features, watch tutorial videos and ask questions at [logistimatics.com/contact](https://logistimatics.com/contact)



### Get Location Link

Send the tracker a command to force it to give a location within 2 minutes (when the device has power only). The tracker will respond with a location point in addition to a link to Google Maps showing that location.